

## Double nipple

Male thread tube-to-tube: BSPP thread, cylindrical  
 Threaded stud: ISO 1179-2 Form E  
 Sealing type: Profile sealing ring PEFLEX  
 Sealing material: Standard NBR

### Reduction

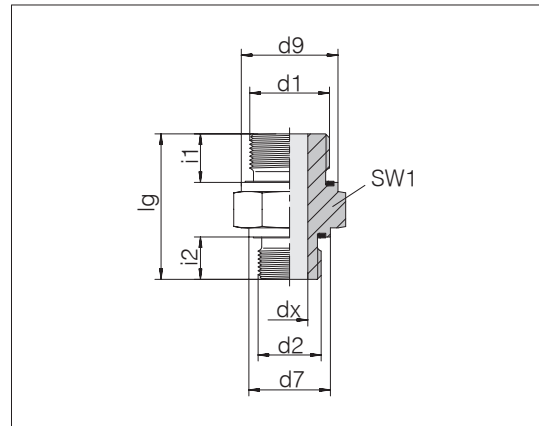

3

d1	d2	Pressure	d7	d9	dx	lg	SW1	i1	i2	Nm -10 % (d1)	kg/100 ca.	Order-No.	Designation	
G 1/4 A	G 1/8 A	PN 500	13.9	18.9	4	29.5	19	12	8	60	20	3.2	1794302000	GP-SD2S-G1/4E-G1/8E-ID4
G 3/8 A	G 1/4 A	PN 630	18.9	21.9	5	36.5	22	12	12	90	60	6.1	1794312000	GP-SD2S-G3/8E-G1/4E
G 1/2 A	G 1/4 A	PN 630	18.5	26.9	5	41	27	14	12	150	60	8.9	1790852000	GP-SD2S-G1/2E-G1/4E
G 1/2 A	G 3/8 A	PN 630	21.9	26.9	8	41.5	27	14	12	150	90	10.5	1798882000	GP-SD2S-G1/2E-G3/8E
G 3/4 A	G 3/8 A	PN 420	21.9	31.9	8	46	32	16	12	200	90	15.0	1790842000	GP-SD2S-G3/4E-G3/8E
G 3/4 A	G 1/2 A	PN 420	26.9	31.9	12	48	32	16	14	200	150	16.8	1794322000	GP-SD2S-G3/4E-G1/2E
G 1 A	G 1/2 A	PN 420	26.9	39.9	12	52	41	18	14	250	150	25.7	1790862000	GP-SD2S-G1E-G1/2E
G 1 A	G 3/4 A	PN 420	31.9	39.9	16	54	41	18	16	250	200	29.4	1794332000	GP-SD2S-G1E-G3/4E
G 1 1/4 A	G 1/2 A	PN 420	26.9	49.9	12	54	50	20	14	500	150	40.2	1790822000	GP-SD2S-G11/4E-G1/2E
G 1 1/4 A	G 3/4 A	PN 420	31.9	49.9	16	56	50	20	16	500	200	41.6	1790872000	GP-SD2S-G11/4E-G3/4E
G 1 1/4 A	G 1 A	PN 420	39.9	49.9	20	58	50	20	18	500	250	47.8	1794342000	GP-SD2S-G11/4E-G1E
G 1 1/2 A	G 1 A	PN 420	39.9	54.9	20	63	55	22	18	600	250	55.7	1790832000	GP-SD2S-G11/2E-G1E
G 1 1/2 A	G 1 1/4 A	PN 420	49.9	54.9	25	65	55	22	20	600	500	69.5	1794352000	GP-SD2S-G11/2E-G11/4E
G 2 A	G 1 1/2 A	PN 160	54.9	74.9	32	70	75	24	22	700	600	117.6	1794362000	GP-SD2S-G2E-G11/2E