

Anaconda stainless steel fittings for Anaconda Sealtite.

The stainless steel Anaconda fittings can be used with all types of Anaconda Sealtite (except CNP). These fittings are available in AISI-303 and AISI-316 and offer superior corrosion resistance. These stainless steel Anaconda fittings are mostly used in the off-shore, chemical and food industry. Because of the UL & CSA approvals the fittings are also suitable for export projects outside Europe.

Material & Construction:

Construction: Stainless steel (AISI-303) fitting, consisting of 4 parts (counter nut, clamping ring, ferrule and body).

Material: Counter nut and body are stainless steel (AISI-303) and the ferrule is from nickel plated brass. Clamping

ring and insert are from PA6 (red for ISO metric, blue for Pg and white for NPT).

Special approvals: UL-514B and CSA C 22.2 (combined UL/CSA file # E 234207).

Suitable for use in hazardous environments according NEC 501-4B Class I, Division 2; Class II, Division 1 and 2; Class III, Division 1 and 2.

Temperature: -45 °C till +105 °C continuous (cable-hose-fittings are -40 °C till +100 °C).

Protection class: IP 67 (dust-proof, water-tight), with cable-hose fittings an IP 68 rate on the switchbox can be obtained.

Colour: Metal.

ANACONDA
SEALTITE®
SPECIAL

LIQUID-TIGHT
FITTINGS FOR
SEALTITE
IP 67

ISO straight fitting, male, stainless steel (AISI-303).

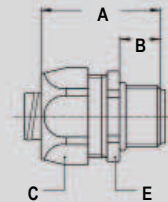
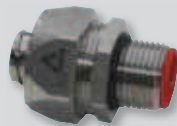

Thread	Sealtite Size (inch)	Min. Internal Bore (mm)	Dimensions in mm					Standard Package	Article Number	Weight (Kg/100)
			A	B	C	D	E			
M16 x 1,5	5/16"	8,3	35	12	27	-	24	10	812.015.9*	5,5
M20 x 1,5	5/16"	8,3	36	13	27	-	24	10	812.014.9*	5,2
M16 x 1,5	3/8"	10,2	35	12	27	-	24	10	812.016.9	5,2
M20 x 1,5	3/8"	10,2	36	13	27	-	24	10	812.017.9	5,5
M20 x 1,5	1/2"	13,9	37	13	30	-	27	10	812.020.9	6,4
M25 x 1,5	3/4"	18,5	40	15	36	-	36	5	812.025.9	8,5
M32 x 1,5	1"	23,8	46	15	46	-	46	5	812.032.9	18,9
M40 x 1,5	1.1/4"	31,8	52	16	54	-	52	2	812.040.9	30,1
M50 x 1,5	1.1/2"	36,8	56	18	63	-	60	2	812.050.9	45,7

* Fittings for 5/16" conduit without UL/CSA approval., a special connection set will be delivered separately.

ISO 45° fitting, male, stainless steel (AISI-303).

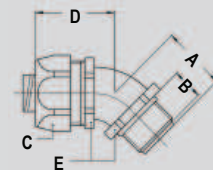

Thread	Sealtite Size (inch)	Min. Internal Bore (mm)	Dimensions in mm					Standard Package	Article Number	Weight (Kg/100)
			A	B	C	D	E			
M16 x 1,5	5/16"	8,3	23	12	27	33	22	10	812.415.9*	8,0
M20 x 1,5	5/16"	8,3	24	13	27	33	22	10	812.414.9*	7,9
M16 x 1,5	3/8"	10,2	23	12	27	33	22	10	812.416.9	7,9
M20 x 1,5	3/8"	10,2	24	13	27	33	22	10	812.417.9	8,0
M20 x 1,5	1/2"	13,9	25	13	30	33	27	10	812.420.9	11,3
M25 x 1,5	3/4"	18,5	30	15	36	36	33	5	812.425.9	14,7

* Fittings for 5/16" conduit without UL/CSA approval., a special connection set will be delivered separately.