

# SWIVEL FITTINGS, IP 67, NICKEL PLATED BRASS

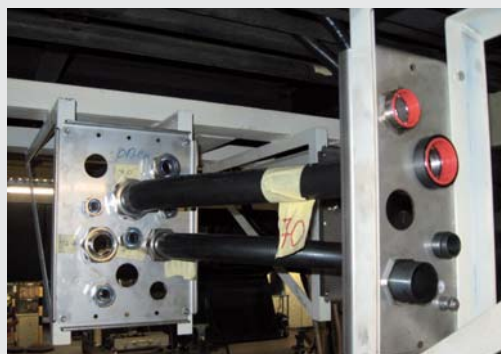

## Anaconda swivel fittings, nickel plated brass, for Anaconda Sealtite

Anaconda **nickel plated brass** swivel fittings can be used with all types of Anaconda Sealtite conduit with the exception of Type CNP. These fittings feature a special swivel mechanism which eliminates torque tension at the conduit and fitting interface, allowing easy installation. All ferrules are turned nickel plated brass, waterproof IP 67 rated and are corrosion resistant.



**Construction:** Nickel plated brass fitting, consisting of 4 parts (counter nut, clamping ring, ferrule and body).  
**Material:** Counter nut and body are nickel plated brass. Clamping ring is made from PA6 and the ferrule is made from nickel plated brass. The O-rings are from NBR rubber (black for ISO).  
**Temperature:** -45 °C till +105 °C continuous  
**Protection class:** IP 67.  
**Colour:** Metal



## ISO straight swivel fitting, male, nickel plated brass

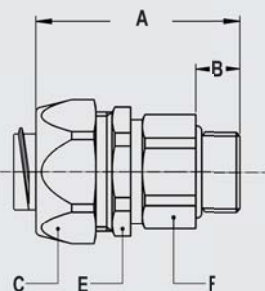

Thread ISO	Sealtite Size (NW)	Min. Internal Bore (mm)	Dimensions in mm						Standard Package	Article Number	Weight (Kg/100)
			A	B	C	E	F				
M16 x 1,5	5/16"	8,3	48	10	26	24	21	10	813.015.0	8,1	
M16 x 1,5	3/8"	10,4	48	10	26	24	21	10	813.016.0	8,1	
M20 x 1,5	3/8"	10,4	49	10	26	25	25	10	813.017.0	8,9	
M20 x 1,5	1/2"	13,8	49	10	29	27	25	10	813.020.0	10,2	
M25 x 1,5	3/4"	17,4	49	10	35	33	31	5	813.025.0	13,8	
M32 x 1,5	1"	23,4	55	12	45	42	38	5	813.032.0	32,5	
M40 x 1,5	1.1/4"	29,4	58	14	54	50	48	2	813.040.0	53,0	
M50 x 1,5	1.1/2"	36,9	65	14	62	58	55	2	813.050.0	74,0	
M63 x 1,5	2"	47,9	74	16	76	72	68	2	813.063.0	130,0	



## ISO 45° swivel fitting, male, nickel plated brass

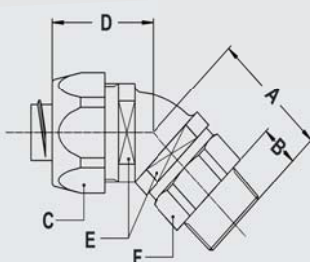

Thread ISO	Sealtite Size (NW)	Min. Internal Bore (mm)	Dimensions in mm						Standard Package	Article Number	Weight (Kg/100)
			A	B	C	D	E	F			
M16 x 1,5	5/16"	8,3	34	10	26	28	22	21	10	813.415.0	9,9
M16 x 1,5	3/8"	10,4	34	10	26	28	22	21	10	813.416.0	9,5
M20 x 1,5	1/2"	13,8	34	10	29	30	27	25	10	813.420.0	13,5
M25 x 1,5	3/4"	17,4	37	10	35	32	33	31	5	813.425.0	21,5
M32 x 1,5	1"	23,4	41	12	45	37	42	38	5	813.432.0	36,5

# SWIVEL FITTINGS, IP 67, NICKEL PLATED BRASS

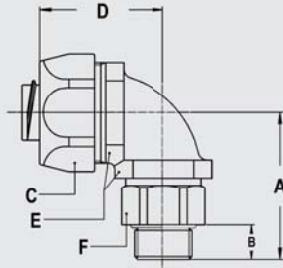

ISO 90° swivel fitting, male, nickel plated brass



Thread	Sealtite Size (NW)	Min. Internal Bore (mm)	Dimensions in mm						Standard Package	Article Number	Weight (Kg/100)
			A	B	C	D	E	F			
M16 x 1,5	5/16"	8,3	39	10	26	35	22	22	10	813.915.0	11,2
M16 x 1,5	3/8"	10,4	39	10	26	35	22	22	10	813.916.0	10,8
M20 x 1,5	1/2"	13,8	39	10	29	37	27	25	10	813.920.0	13,2
M25 x 1,5	3/4"	17,4	46	10	35	44	33	31	5	813.925.0	22,8
M32 x 1,5	1"	23,4	55	12	45	55	42	38	5	813.932.0	41,4

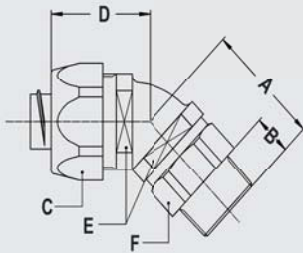

NPT 45° swivel fitting, male, nickel plated brass



Thread	Sealtite Size (NW)	Min. Internal Bore (mm)	Dimensions in mm						Standard Package	Article Number	Weight (Kg/100)
			A	B	C	D	E	F			
NPT 1/2"	5/16"	8,3	36	12	26	28	22	22	10	819.411.0	11,9
NPT 1/2"	3/8"	10,4	36	12	26	28	22	22	10	819.412.0	11,5
NPT 1/2"	1/2"	13,8	36	12	29	30	27	25	10	819.416.0	14,0
NPT 3/4"	3/4"	17,4	39	12	35	32	33	31	5	819.420.0	22,0
NPT 1"	1"	23,4	42	13	45	37	42	38	5	819.426.0	37,0

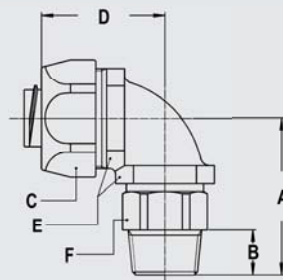

NPT 90° swivel fitting, male, nickel plated brass



Thread	Sealtite Size (NW)	Min. Internal Bore (mm)	Dimensions in mm						Standard Package	Article Number	Weight (Kg/100)
			A	B	C	D	E	F			
NPT 1/2"	5/16"	8,3	41	12	26	35	22	22	10	819.911.0	12,4
NPT 1/2"	3/8"	10,4	41	12	26	35	22	22	10	819.912.0	12,0
NPT 1/2"	1/2"	13,8	41	12	29	37	27	25	10	819.916.0	14,0
NPT 3/4"	3/4"	17,4	48	12	35	44	33	31	5	819.920.0	23,5
NPT 1"	1"	23,4	56	13	45	55	42	38	5	819.926.0	42,0

General Index  
Anaconda Multiflex  
Anaconda Multitite  
Anaconda Sealrite  
Anaconda Sealrite Spec.  
Anaconda Fittings