

No. 6990-20-G

Measuring coupling

for threaded connection.



CAD



Order no.	Article no.	Pressure max. [bar]	E	G	L	SW	Weight [g]
321893	6990-20-G1/8	400	8,0	G1/8	39	17	70
321877	6990-20-G1/4	630	12,0	G1/4	37	19	70

Application:

The measuring coupling is used for pressure monitoring or venting with the measuring hose.

Note:

Adaptation is possible under pressure up to max. 400 bar.

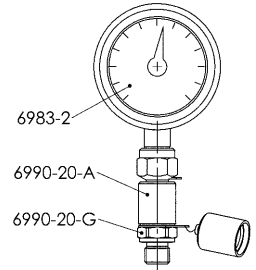
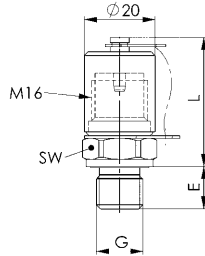

No. 6990-20-R

Measuring coupling

for pipe connection.



CAD



Order no.	Article no.	Pressure max. [bar]	dia. D	E	G	L	SW	SW1	Weight [g]
321984	6990-20-R	630	8	16,5	M16x1,5	35	17	19	70

Application:

The measuring coupling is used for pressure monitoring or venting.

Note:

Adaptation is possible under pressure up to max. 400 bar.

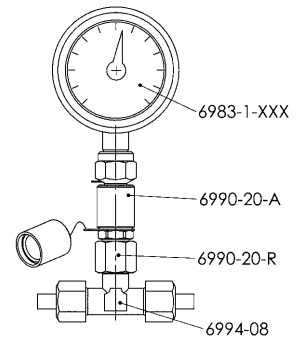
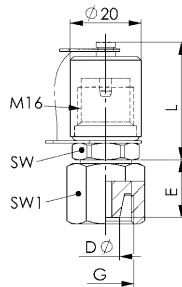

No. 6990-20-S

Measuring hose

max. operating pressure 630 bar,
max. dynamic operating pressure 500 bar.
Temperature -20 to +100 °C.

Order no.	Article no.	Inside dia. [mm]	Outside dia. [mm]	Length [mm]	Bending radius min. [mm]	Connection thread	Weight [g]
321919	6990-20-S400	2	5	400	20	M16	75
321935	6990-20-S1000	2	5	1000	20	M16	100

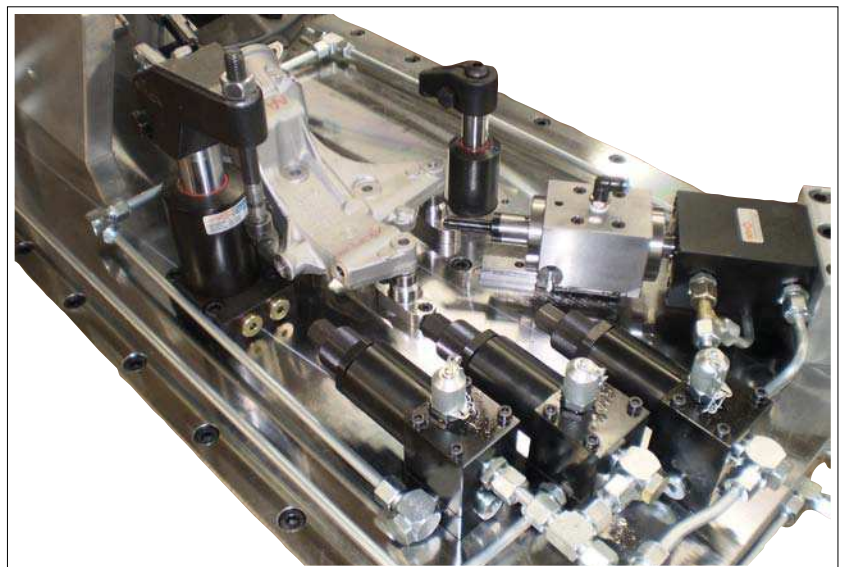

Subject to technical alterations.