

No. 6994-11

Screw-in fitting, straight, heavy-duty

for steel tubes with outer diameter 8 mm and internal diameter 4 mm, with olive ring.



CAD

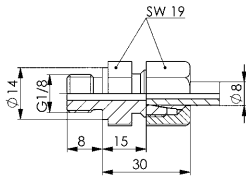

Order no.	Article no.	max. operating pressure [bar]	Md max. [Nm]	Weight [g]
112714	6994-11	400	40	55

Design:

To DIN 3852 form B by sealing edge or by sealing edge ring and olive ring or O-ring.

Note:

Warning: Do not use Teflon tape!

No. 6994-12

Pivoting fitting, angled, heavy-duty

for steel tubes with outer diameter 8 mm and internal diameter 4 mm, with olive ring.



CAD

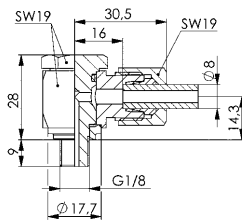

Order no.	Article no.	max. operating pressure [bar]	Md max. [Nm]	Weight [g]
112961	6994-12	400	40	125

Design:

To DIN 3852 form B by sealing edge or by sealing edge ring and olive ring or O-ring.

Note:

Warning: Do not use Teflon tape!

No. 6994-13

Pivoting T-fitting, heavy-duty

for steel tubes with outer diameter 8 mm and internal diameter 4 mm, with olive ring.



CAD

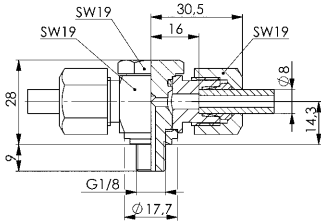

Order no.	Article no.	max. operating pressure [bar]	Md max. [Nm]	Weight [g]
116418	6994-13	400	40	150

Design:

To DIN 3852 form B by sealing edge or by sealing edge ring and olive ring or O-ring.

Note:

Warning: Do not use Teflon tape!

No. 6994-14

Bulkhead fitting, straight, heavy-duty

for steel tubes with outer diameter 8 mm and internal diameter 4 mm, with olive ring.



CAD

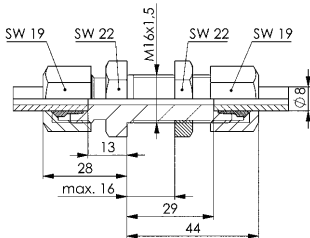

Order no.	Article no.	max. operating pressure [bar]	Weight [g]
131631	6994-14	800	130

Design:

To DIN 3852 form B by sealing edge or by sealing edge ring and olive ring or O-ring.

Note:

Warning: Do not use Teflon tape!

No. 6994-17

Union nut with cutting ring, heavy series

for steel tubes with outer diameter 8 mm and internal diameter 4 mm, with olive ring.



CAD

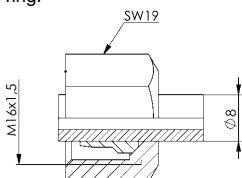

Order no.	Article no.	max. operating pressure [bar]	Weight [g]
184150	6994-17	800	23

Design:

According to DIN 3852 Form B by cutting ring.

Note:

Warning: Do not use Teflon tape!